

APPLICATION FOR FREE MEMBERSHIP

Name: _____

Address: _____

Telephone: _____

Email: _____

Please provide a suitable I.D photograph (passport type, clear headshot) to be printed on your access permit

In connection with the facilities granted to me/us by Forterra Building Products Limited or its subsidiaries for:-

ACCESS TO KINGS DYKE NATURE RESERVE
TO 31ST MARCH 2018

It is understood, agreed and it is a condition of the grant that the facilities are to be used at my/our own risk and in consideration of such grant I/we hereby undertake to indemnify Forterra Building Products and its subsidiaries against all claims and demands, losses and costs, which may arise out of, or be incurred in connection with such use (except in respect of liability that may be incurred by Forterra Building Products or its subsidiaries for negligence of breach of contract), and to make good at my/our expense any damage occasioned to Forterra Building Products or its subsidiaries on their property by such use.

Signed: _____

Name in capitals: _____

Date: _____

In the presence of:

Name in capitals: _____

Date: _____

Address: _____

Occupation: _____

Additional information:

Where did you hear about us? _____

Reason for joining? _____

Do you require a bird hide access key? _____

Return form to:

Philip Parker Associates : White Row Cottage : Leziate Drove :
Pott Row : King's Lynn : Norfolk : PE32 1DB

HOW TO FIND US

King's Dyke Nature Reserve, Peterborough Road, Whittlesey

Situated on the A605 between Stanground and Whittlesey.

By Car: If approaching from Peterborough, continue over the level crossing past the entrance to Forterra Brickworks on the left. Turn left signposted 'Forterra Sales Office'. Parking is in the sales office car park. The reserve entrance is to the rear of the car park.

By Bus: Stagecoach (Queensgate Bus Station) - Route 31/33 and Judd's Travel Route 701

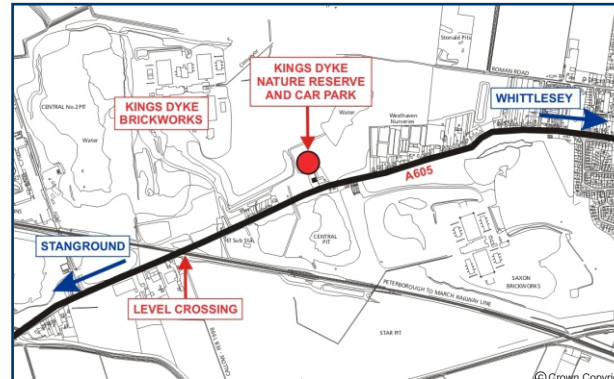

Facilities:

Free car park, bird hide, elevated viewing points, fossil hunting, pond dipping, nature trail and regular events organised.



Enquiries: Contact Phil Parker

Tel: 01553 630842

Email: admin@philipparkerassociates.co.uk

Website: www.kingsdykenaturereserve.com



KINGS DYKE NATURE RESERVE

