



Kings Dyke Nature Reserve

Come and experience nature first hand. Hidden from view, you would never know that you were just a stones throw away from one of the largest brickworks in Europe, with only 3 tall chimneys in view as a reminder. Kings Dyke Nature Reserve offers a peaceful place to observe a wide range of wildlife, as well as trying your hand at some of the activities we have to offer.

This area of clay extraction (dating back to the 1920's) was restored in 1995 and it is now a wonderful example of how industrial land can be transformed to benefit both wildlife and the local community.

Local schools and colleges are also encouraged to use the facilities provided. Forterra Building Products Limited have developed educational activities to help teachers provide their students with a 'hands on' outdoor education.

All this is available FREE OF CHARGE!

FOSSIL HUNTING

Dig up your very own Jurassic fossils in our fossil hunting area. This area provides a safe environment with fresh clay from the quarry for you to dig through. A small hand trowel is all you require to separate the clay and find fossils in their hundreds! Just some examples of what you might find are: Ammonites, Belemnites, Worm Burrows, Devil's Toenails, if you are lucky you may come across more scarce finds such as Ichthyosaur vertebrae or a Crocodile/Pleaiosaur tooth!



BIRD WATCHING

Sit quietly in our bird hide overlooking the main lake. 125 species have been recorded to date including regular sightings of Kingfisher, Reed Bunting, Turtle Dove, Marsh Harrier, Lapwing, Peregrine and Snipe. You are encouraged to add any sightings to the log book in the hide.



Kings Dyke Nature Reserve participates in the bi-annual BTO Business Bird Challenge. All sightings are added to our ever expanding data base which contributes towards the competition and helps monitor the success of the site management work.



One of the largest reedbeds in Peterborough is part of the new Kings Dyke Nature Reserve extension

POND DIPPING

Our pond dipping platform provides a safe place to catch and observe the abundant wetland wildlife. Nets and identification sheets are provided.



NATURE TRAIL

Take a walk around our nature trail. The route takes you on a fun and informative walk providing panoramic views of the reserve and gives the opportunity to experience a mosaic of habitats and the wildlife using them.

EVENTS

Regular events include moth trapping, reptile/amphibian surveys, bug hunt, brickwork/nature reserve tours, archaeological and fossil displays. Kings's Dyke Nature Reserve is also open once a year to the general public during May/June, where these and many additional activities can be undertaken.

BECOMING A MEMBER

Access to the Nature Reserve is via a FREE permit.

Simply fill out the form overleaf and return it to the stated address.

You will then receive a Permit Pack containing the following:

- * Rules and guidelines
- * Permit
- * Bird hide key
- * Species Lists
- * Fossil identification sheet
- * Copy of the latest newsletter
- * Plan of the reserve

Whilst the reserve is on private land we are keen that interested people are able to study and enjoy the wildlife and watch its development over the future years.

In particular the company is working with local schools to maximise the value of the site for children and their understanding of environmental issues through the National Curriculum. We therefore ask you to respect the Nature Reserve Code (which will be included within your welcome pack), in particular the "No dogs rule" and help the Company in keeping the reserve in a condition for everyone to enjoy.

Access to the Nature Reserve is strictly on the understanding that members stay within the fences (they are there for your safety) and that children are supervised by a responsible adult at all times.



Local school children learn about the brick making process on a tour of the brickworks

APPLICATION FOR FREE MEMBERSHIP

Name: _____

Address: _____

Telephone: _____

Email: _____

Please provide a suitable I.D photograph (passport type, clear headshot) to be printed on your access permit

In connection with the facilities granted to me/us by Forterra Building Products Limited or its subsidiaries for:

**ACCESS TO KINGS DYKE NATURE RESERVE
TO 31ST MARCH 2020**

It is understood, agreed and it is a condition of the grant that the facilities are to be used at my/our own risk and in consideration of such grant I/we hereby undertake to indemnify Forterra Building Products and its subsidiaries against all claims and demands, losses and costs, which may arise out of, or be incurred in connection with such use (except in respect of liability that may be incurred by Forterra Building Products Limited or its subsidiaries for negligence or breach of contract), and to make good at my/our expense any damage occasioned to Forterra Building Products Limited or its subsidiaries on their property by such use.

Data protection:

I tick to give my consent for any personal data provided to be held by Philip Parker Associates Ltd, on a secure database. This is in order to manage nature reserve membership. I reserve the right to request the removal of my personal data from the database at any time. I understand that such personal data is never shared/sold with/to any third party and is used for nature reserve administration only.

Tick box to consent

Signed: _____

Name in capitals: _____

Date: _____

In the presence of:

Name in capitals: _____

Date: _____

Address: _____

Additional information:

Where did you hear about us? _____

Reason for joining? _____

Do you require a bird hide access key? _____

Return form to:

Philip Parker Associates : White Row Cottage : Leziat Drive : Pott Row :
King's Lynn : Norfolk : PE32 1DB

HOW TO FIND US

King's Dyke Nature Reserve, Peterborough Road, Whittlesey

Situated on the A605 between Stanground and Whittlesey.

By Car: If approaching from Peterborough, continue over the level crossing past the entrance to Forterra Brickworks on the left. Turn left signposted 'Forterra Sales Office'. Parking is in the sales office car park. The reserve entrance is to the rear of the car park.

By Bus: Stagecoach (Queensgate Bus Station) - Route 31/33 and Judd's Travel Route 701.

Access all year via free permit.

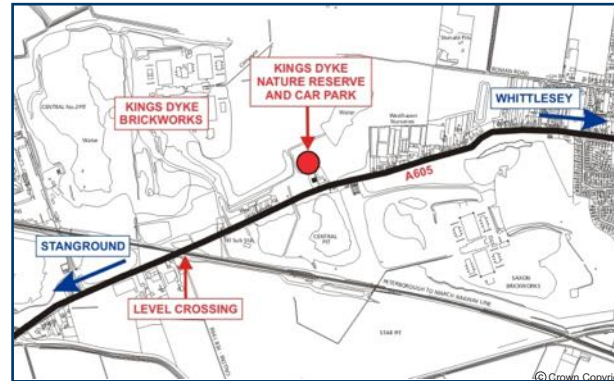

Facilities:

Free car park, bird hide, elevated viewing points, fossil hunting, pond dipping, nature trail and regular events organised.



Enquiries: Contact Phil Parker

Tel: 01553 630842

Email: admin@philipparkerassociates.co.uk

Website: www.kingsdykenaturereserve.com



KINGS DYKE NATURE RESERVE

